

PROXIMITY SENSOR

Model : PX-01

ISO-9001, CE, IEC1010

www.yalab.com.tw

02-2389-0101



Y Lutron

www.YaLAB.com.tw

The Art of Measurement

PROXIMITY SENSOR

Model :PX-01

Operating voltage	10 to 30 VDC.
Off-state leakage current	< = 10 uA
Standard Sensing object	Iron 18 x 18 x 1 mm.
Sensing distance	4 mm.
Sensing direction	Vertical.
Response frequency	600 Hz.
Output state	DC 3 wires NPN normally opening.
Switching current	200 mA
Circuit protection	Load short circuit protection, polarity protection
Output method	PNP, NO (normal open)
Delay reading	100 ms.
Operating Temperature	-20 to 70 °C
Operating Humidity	35 to 95 %RH.
Current consumption	15 mA (DC 24V), no load.
Output current	250 mA max.
Leakage current	1.1 mA.
Residual voltage	0.9 VDC.
Protection degree	IEC IP-67
Wire Dimension	4.7 mm Dia. x 2 m x 3 cores.
Application	* Sensor for panel tachometer, DT-2240D. * Sensor for RPM controller/monitor PDT-2250 * Position Detector.

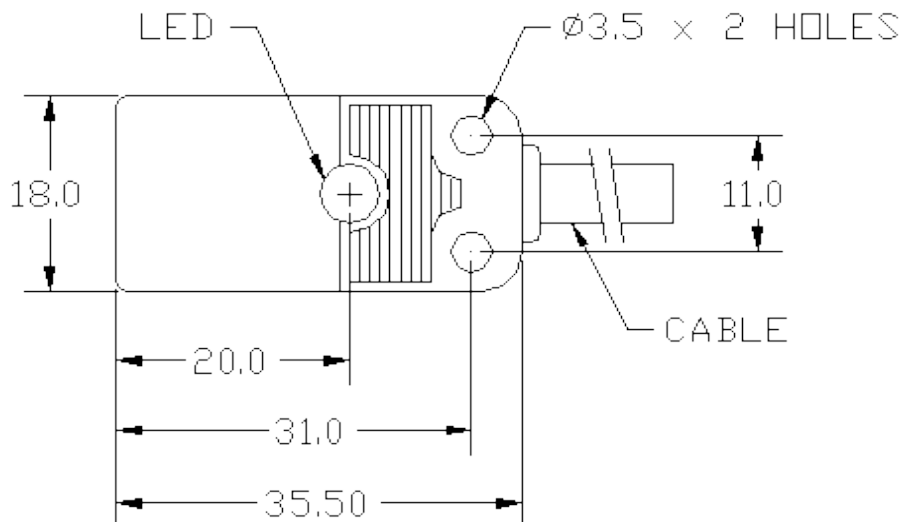
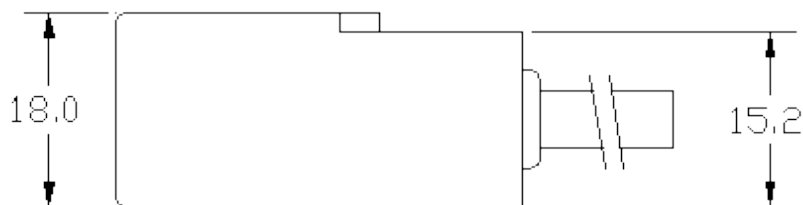

* Appearance and specifications listed in this brochure are subject to change without notice. PX01-1110

www.YaLAB.com.tw 02-2389-0101